



4200170

**REFRIGERATOR FAN MOTOR REPLACEMENT COMPONENTS**

**CONTAINS:**

QTY	DESCRIPTION	QTY	DESCRIPTION
1	Fan Bracket: 211, 241, 251, 361, 3211, 201R, 215R, 2011ICE Ref., 2711, 2811	4	Grommet
1	Fan Bracket: 511, 532, 550, 561, 611, 632, 642, 650, 680, 690	1	Black Wire Grommet
1	Fan Bracket: 632, 642, 650, 680, 690, 601RG, 611G, 650G	1	Green Ground Wire, 8"
1	White Wire Plug	2	Screw, #10-32 x 1/4 Round Head
1	Fan Motor	1	Ground Screw, #8-32 x 1/2 Pan Head
		1	Instructions

**⚠ WARNING** TO AVOID ELECTRICAL SHOCK, DISCONNECT ELECTRICAL POWER TO EQUIPMENT WHEN ATTEMPTING THIS REPAIR.

**PROCEDURE:**

- Remove defective fan motor assembly.
- Match existing fan bracket with bracket in package.  
**NOTE:** On models 632, 642, 680, 690 between serial #1810000 and approximately serial #2064651, and models 601RG, 611G and 650G, the service bracket differs from the original bracket, see diagrams 3 and 4 on next page.  
**NOTE:** On models 700TR-2, 700TC-2, 700TR-3 and 700TC-3 the production bracket must be reused.
- On models 511, 532, 550, 561, 611, 632, 642, 650, 680, & 690, prior to serial #1810000 and after approximate serial #2064651, mount fan motor to bracket with #10-32 screws.  
**NOTE:** Brass inserts from existing fan bracket will be reused.
- Secure green ground wire to fan bracket using #8-32 ground screw.
- Route pink and white wires of motor down through hole in fan bracket, secure with black wire grommet.  
**NOTE:** Grommet must be used to prevent wire/blade interference.
- Insert green ground wire into terminal #3 of enclosed white wire plug. The white (neutral) wire goes into terminal #2, the pink (power) wire goes into terminal #1. (See Diagram 1)
- Make sure fan blade is positioned properly (See Diagram 2 and table and/or appropriate service manual for proper fan blade spacing).
- Restore electrical power to equipment.

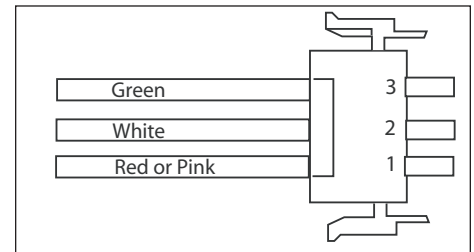

Diagram 1

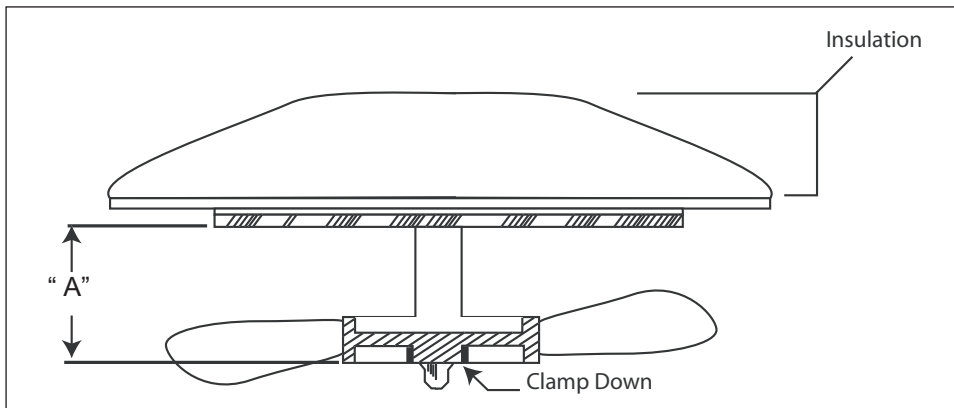
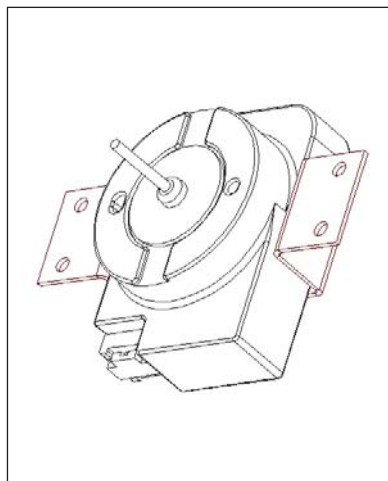

Diagram 2

Model	"A"
500/600Series (PTS#1810000)	1-1/4"
632/642 (Srl#1810000-2064651)	7/8"
632/642 (SWS#2064651)	1-1/4"
661	7/8"
690 (Srl#1810000-2066436)	7/8"
690 (SWS#2066436)	1-1/4"
<b>NOTE:</b> model 680 motor shaft tip must be flush with blade hub.	
600-2 Series -	
- (Except 611G/650G/661)	1-1/4"
611G-2/650G-2/661-2	7/8"
600-3 Series -	
- (Except 611G/650G/661)	1-1/4"
611G-3/650G-3/661-3	7/8"
700TC/I-3 (Upper)	1"
736TC/I-3 (Upper)	7/8"
700TR/I-3 (Upper)	1"
736TR/I-3 (Upper)	7/8"
700TR/I-3/736TC/I-3 (Lower)	1"

On models 632, 642, 680, 690 between serial #1810000 and approximately serial #2064651, and models 601RG, 611G and 650G, the service bracket differs from the original bracket, see diagrams 3 and 4 below.



**Diagram 3**  
**Production Fan Assembly**

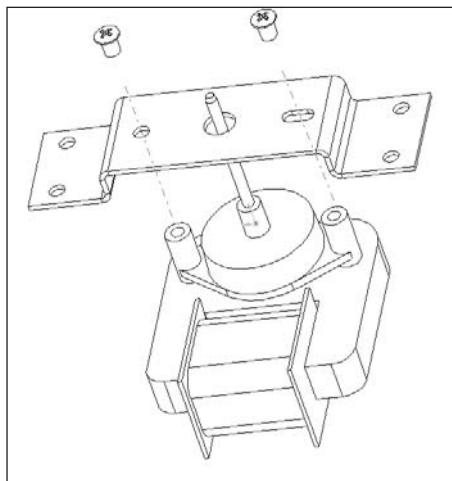

**Diagram 4**  
**Service Fan Assembly**